

FEATURES:

- LOW INSERTION LOSS
- HIGH Tx to Rx REJECTION
- LIGHT WEIGHT
- RUGGED CONSTRUCTION

ELECTRICAL CHARACTERISTICS:

Operating Frequency Range : 37.000 to 40.000 GHz

Operating Temperature Range : -30°C to +70°C

Part Number	T/R Spacing	Rx Filt. B.W.	Tx Filt. B.W.	R.L. All Ports	I.L. @ Fo	Rejection Frequency	Tx to Rx Rejection
AD28-0002	1260 MHz	300 MHz	300 MHz	20 dB min.	2.0 dB max.	Fo ± 1200 MHz	70 dB Min.

Specifications are subject to change for continuous improvement.

MECHANICAL CHARACTERISTICS:

- a) Dimensions are in inches (millimeters)
- b) Interface: WR28/UG-1665/U Flange, SMA-F connector
- c) Finish: Silver Plate QQ-S-365 Type II, Grade A
- d) Material: Alum.6061T6

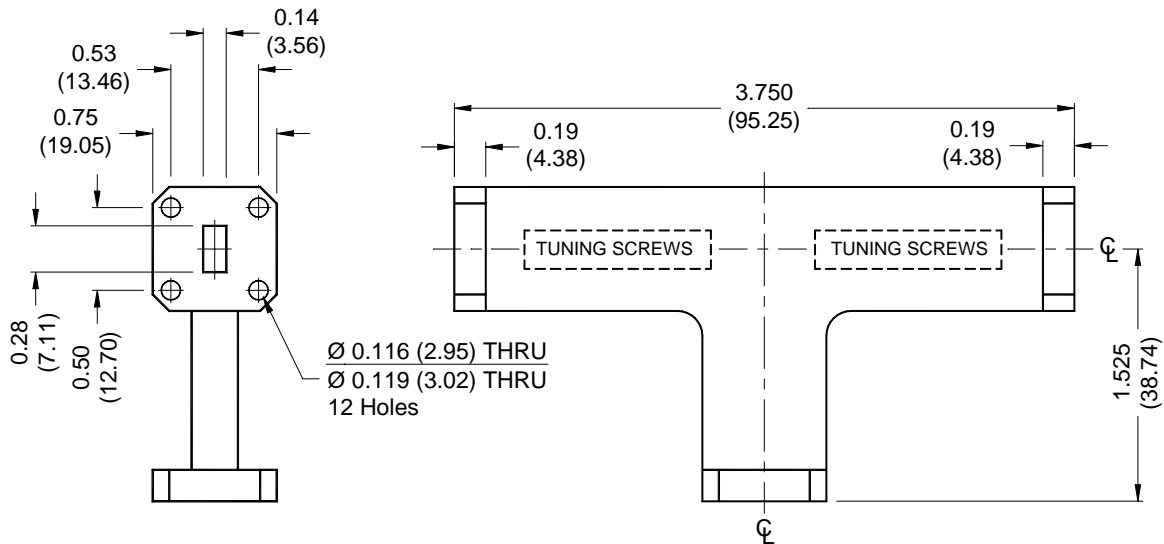

Note: Other Diplexer configurations are available.