

Coaxial Splitter/Combiner

ComPlus™ Series

TSI 1450-020-01
2.8-7.0GHz

Features

- Ideal for the following applications:
WLL, ISM, UNII, and C Band
- Designed for wideband application
- Low insertion loss
- Low phase unbalance

Overall Specification

Electrical Specs	Max.	Units
Frequency Range	2.8-7.0	GHz
Insertion Loss	3.3	dB
Isolation	20	dB
Return Loss	19	dB
Max RF Power	40	W
Phase Balance	3	deg
Amplitude Balance	0.3	dB
Mechanical Specs		
Connectors	SMA-TYPE-F	
Housing Material	AL 6061T6	
Operating Temp.(°C)	-40 to +85	
Storage Temp. (°C)	-40 to +85	
Dimensions (inches)	0.5 X 2.1 X 2.8	



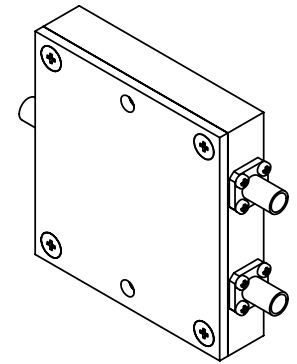
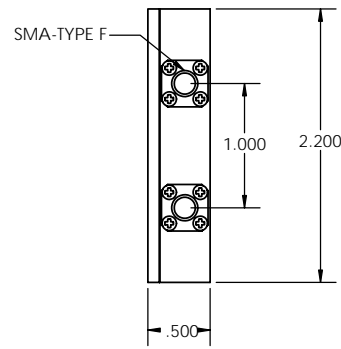
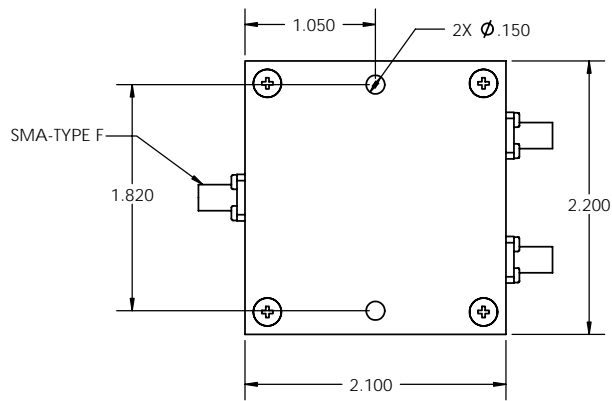
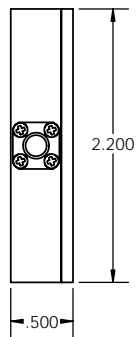
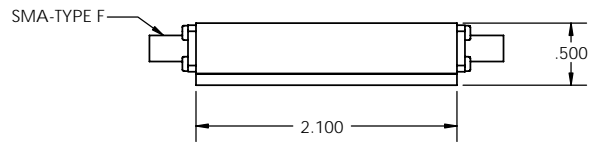

THE INFORMATION CONTAINED IN THIS DRAWING IS THE SOLE PROPERTY OF TRACKCOM SYSTEMS INC. ANY REPRODUCTION IN PART OR WHOLE WITHOUT THE WRITTEN PERMISSION OF TRACKCOM SYSTEMS INC. IS PROHIBITED.

UNLESS OTHERWISE SPECIFIED DIMENSIONS ARE IN INCHES TOLERANCES ARE: FRACTIONS DECIMALS ANGLES + .XX ± .01 + 1 XXX ± .005		CAD GENERATED DRAWING. DO NOT MANUALLY UPDATE		TRACKCOM SYSTEMS INC.	
APPROVALS		DATE		TITLE	
DESIGNED <i>I. Warsame</i>				2.8-7.0GHz Coaxial Power Divider SMA-F Connector	
CHECKED <i>I. Warsame</i>				REVISION:	
MATERIAL Aluminium		SIZE	FILE NO	1450-020-01-DO-01	
FINISH Clear Iridite		MFG ENG			
DO NOT SCALE DRAWING		QUAL ENG	SCALE	1:1	SHEET 1 OF 1